

Aerial Map

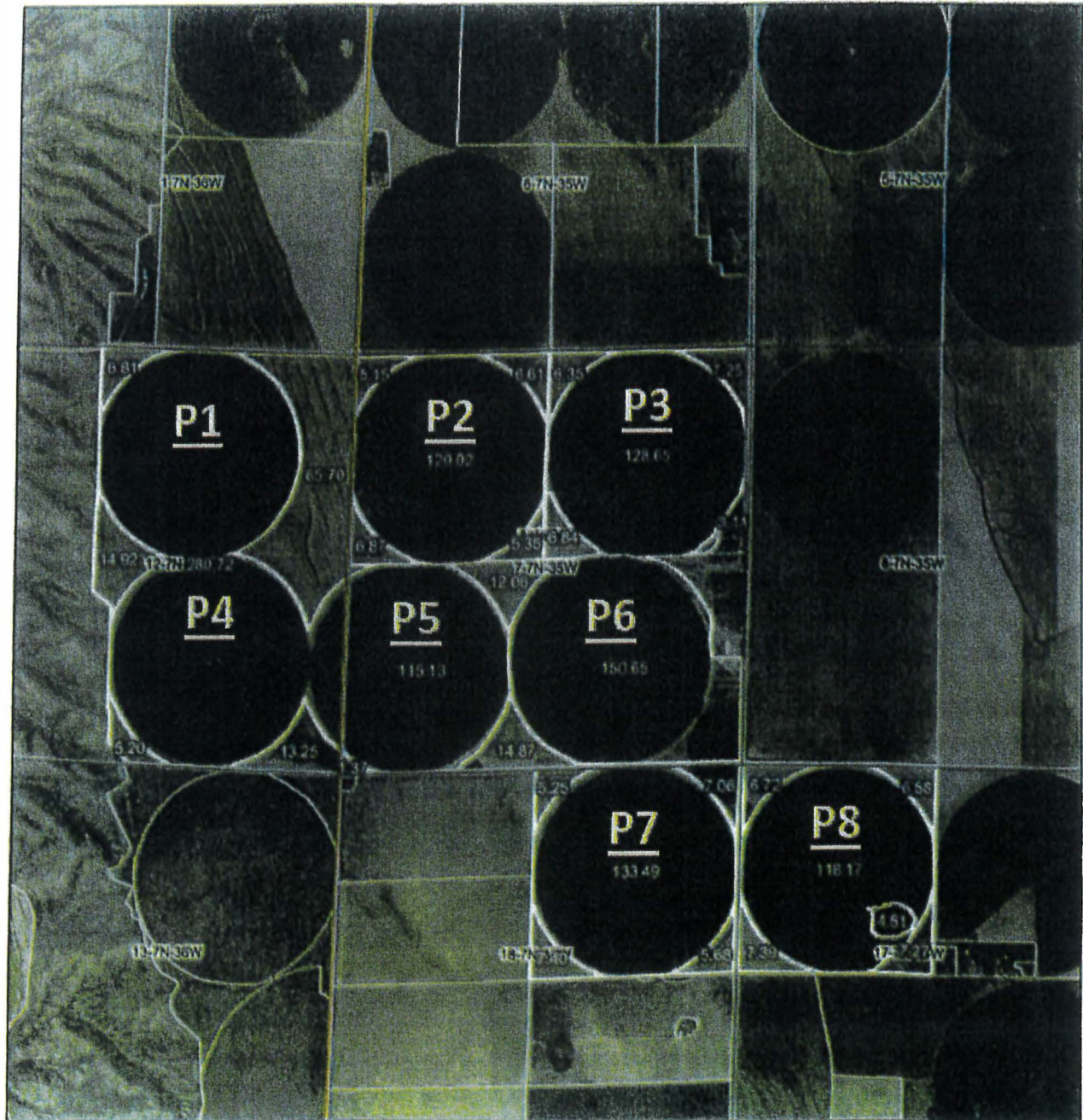

Boundary Center: 40° 35' 7.76, -101° 20' 11.43

OR 1996R 3992R

7-7N-35W
Hayes County
Nebraska



Maps Provided By
surety
SUTHERLAND ONLINE MAPPING
© 2013 SUTHERLAND ONLINE MAPPING
www.SuretyOnline.com

Field borders provided by Farm Service Agency as of 2012/2013

Soils Map

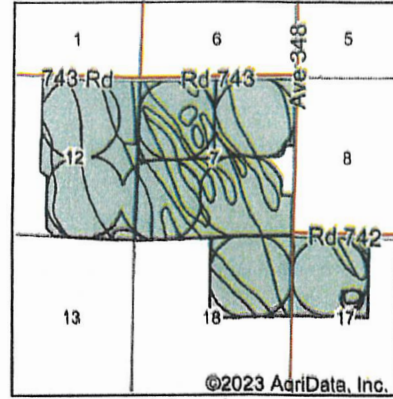
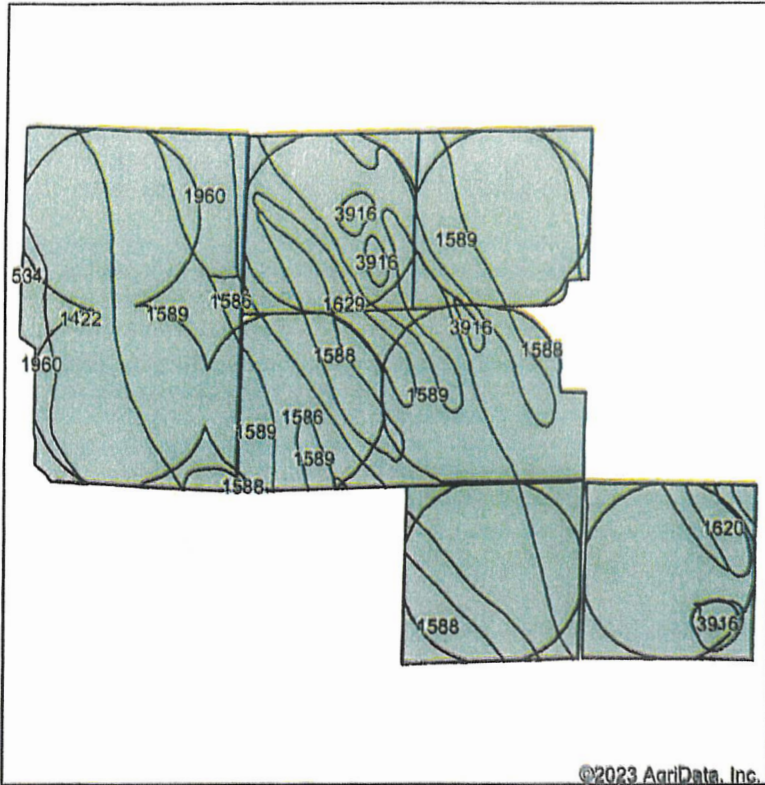

State: **Nebraska**
 County: **Hayes**
 Location: **7-7N-35W**
 Township: **Antelope**
 Acres: **1295.4**



Soils data provided by USDA and NRCS.

Area Symbol: NE029, Soil Area Version: 24
 Area Symbol: NE085, Soil Area Version: 23

| Code | Soil Description | Acres | Percent of field | Non-Irr Class *c | Irr Class *c | SRPG | Alfalfa hay Irrigated Tons | Corn Irrigated Bu | Corn Bu | Grain sorghum Bu | Grain sorghum Irrigated Bu | Winter wheat Bu | Winter wheat Irrigated Bu | *n NCCPI Soybeans |
|------|---|--------|------------------|------------------|--------------|------|----------------------------|-------------------|---------|------------------|----------------------------|-----------------|---------------------------|-------------------|
| 1588 | Blackwood silt loam, 0 to 1 percent slopes | 444.36 | 34.3% | IIc | Iw | 66 | 6 | 144 | 40 | 40 | 114 | 45 | | 55 |
| 1589 | Blackwood silt loam, 1 to 3 percent slopes | 331.39 | 25.6% | Ile | Ile | 65 | 5 | 139 | 38 | 38 | 104 | 40 | | 61 |
| 1589 | Blackwood silt loam, 1 to 3 percent slopes | 163.95 | 12.7% | Ile | Ile | 65 | 5 | 139 | 38 | 38 | 104 | 40 | | 61 |
| 1422 | Goshen silt loam, rarely flooded | 141.37 | 10.9% | IIIc | Iw | | 5 | 118 | | 34 | 98 | 34 | 69 | 55 |
| 1960 | Buffalo Park silt loam, 3 to 6 percent slopes | 70.44 | 5.4% | IVe | IVe | | | | | 6 | | 5 | | 52 |
| 1586 | Blackwood silt loam, 3 to 6 percent slopes | 69.30 | 5.3% | Ile | Ile | 63 | 5 | 140 | 38 | 38 | 105 | 40 | | 60 |
| 1629 | Keith silt loam, 3 to 6 percent slopes | 26.85 | 2.1% | IIIe | IIIe | 64 | | | | | | | | 57 |

Soils data provided by USDA and NRCS.

